

Pick Up and Drop Off Map

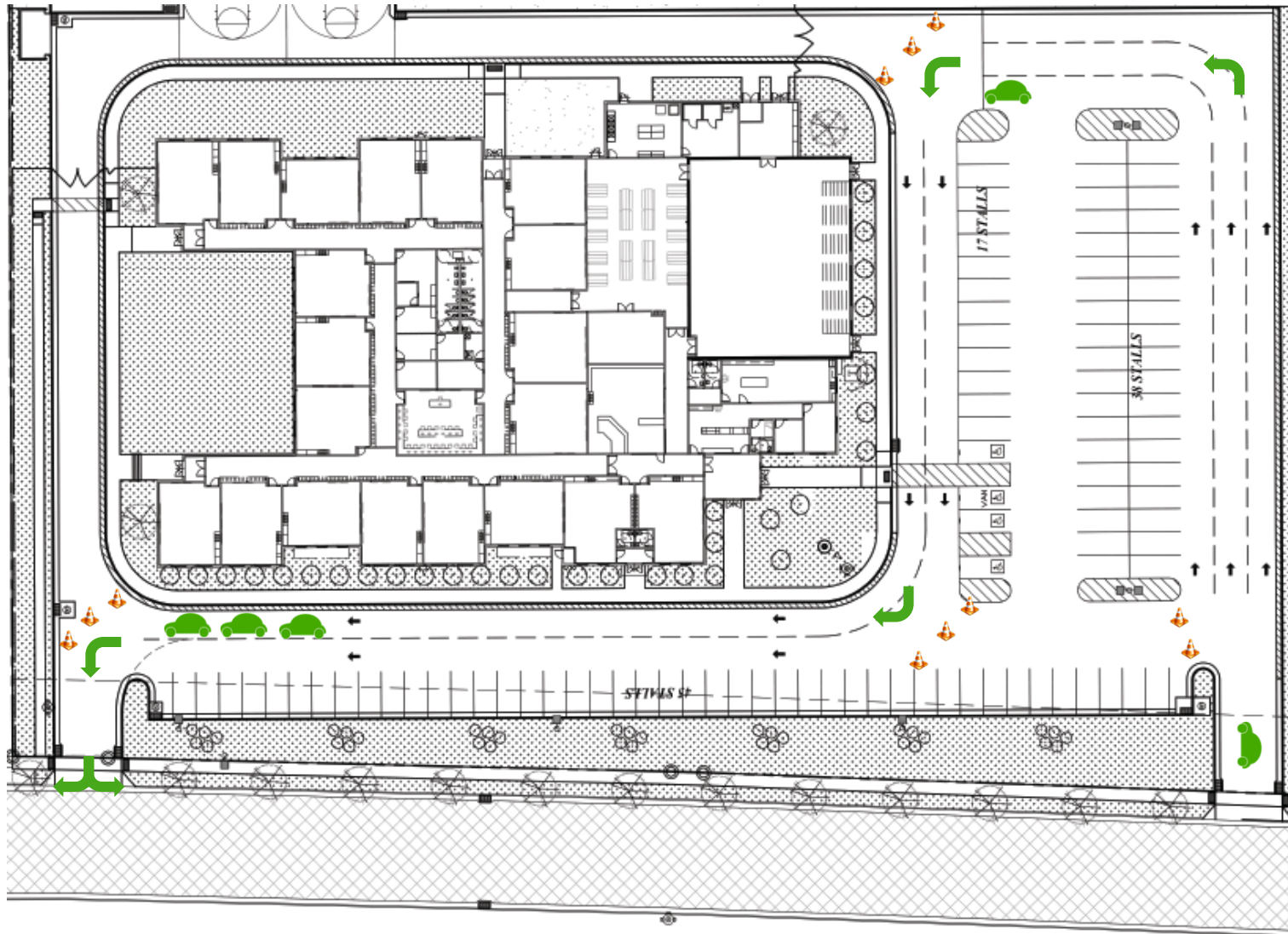

Pick Up and Drop Off Procedures

To ensure the safety of your children and yourself, please follow the below protocols.

PROCEDURES

- Enter the parking lot from the south entrance on 100 east.
- Pull forward, as directed by staff, into one of the three stacking lanes at the southwest corner of the building.
- When a staff member indicates, turn a slight left around the front of the building and pull forward alongside the curb as far forward as possible toward the northeast corner of the building staying in the right lane preferably.
- Unload or load students from the right side of the vehicle. Check for seat belt security.
- Check traffic and enter the left passing lane pulling forward to the north end of the parking lot toward the exit at the northwest corner of the school parking lot.
- Turn right or left onto 100 east.

GENERAL GUIDELINES

- Please be patient and courteous toward Scholar Academy faculty and staff, students, and other drivers.
- Be on the lookout for students using the crosswalks in the parking lot.
- Stay in your vehicle at all times. If you need to get out of your vehicle please park in a stall on the south side of the parking lot.
- Refrain from mobile phone usage while driving on school grounds.
- Students will exit and enter from the RIGHT side of the vehicle only and at the CURB only.
- Note: By law, all vehicle occupants must be secured in a seat belt and children under eight (8) years old must be in a car seat or booster before vehicle is in motion.

HELPFUL HINTS

- Arrange a location for all of the students riding with you to meet.
- When waiting in the car for your students, please turn off the engine.